

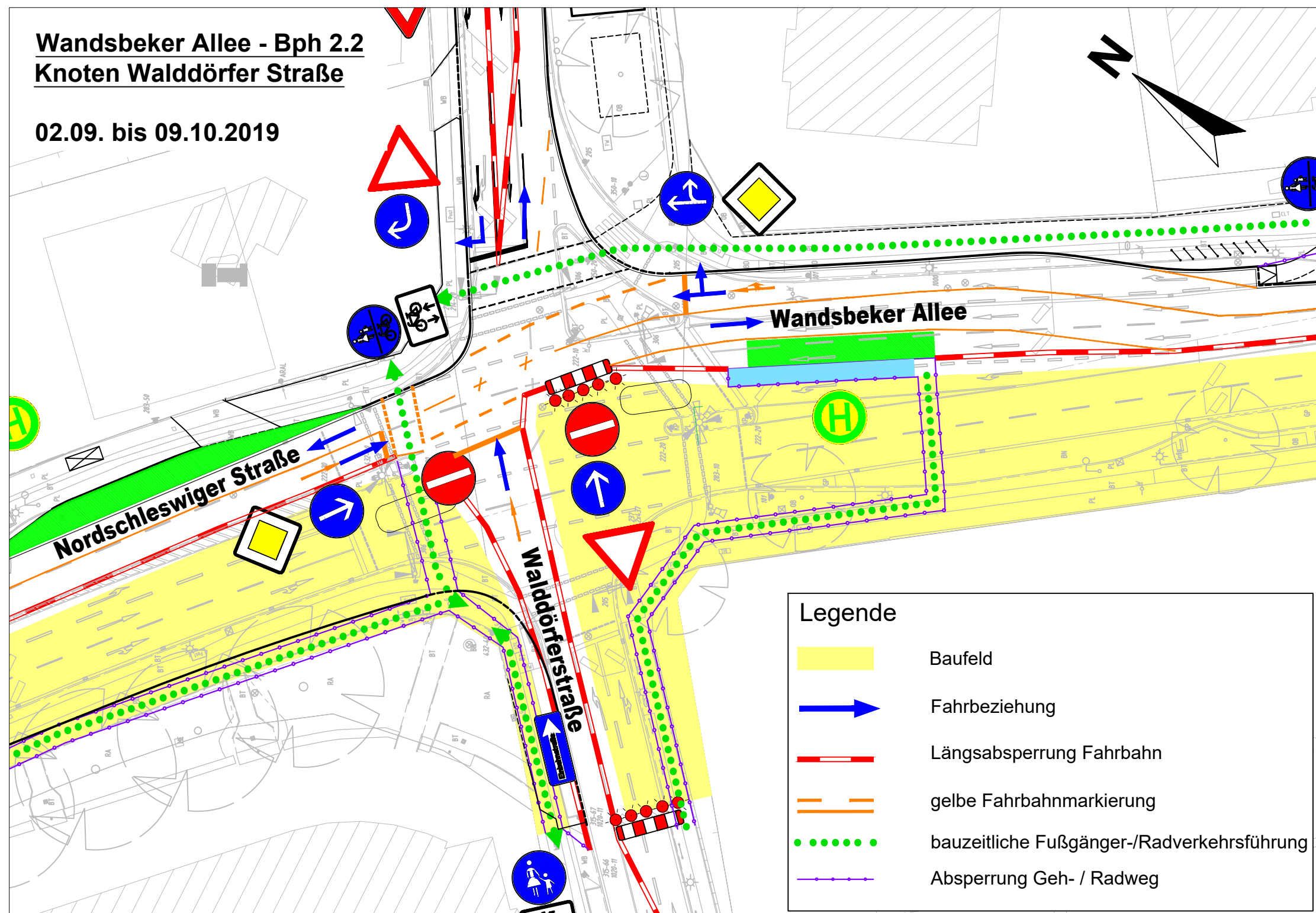

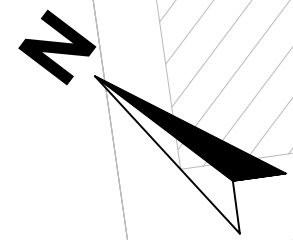



# Wandsbeker Allee - Bph 2.2 Knoten Walddörfer Straße

02.09. bis 09.10.2019



Legende	
	Baufeld
	Fahrbeziehung
	Längsabsperzung Fahrbahn
	gelbe Fahrbahnmarkierung
	bauzeitliche Fußgänger-/Radverkehrsführung
	Absperrung Geh- / Radweg